

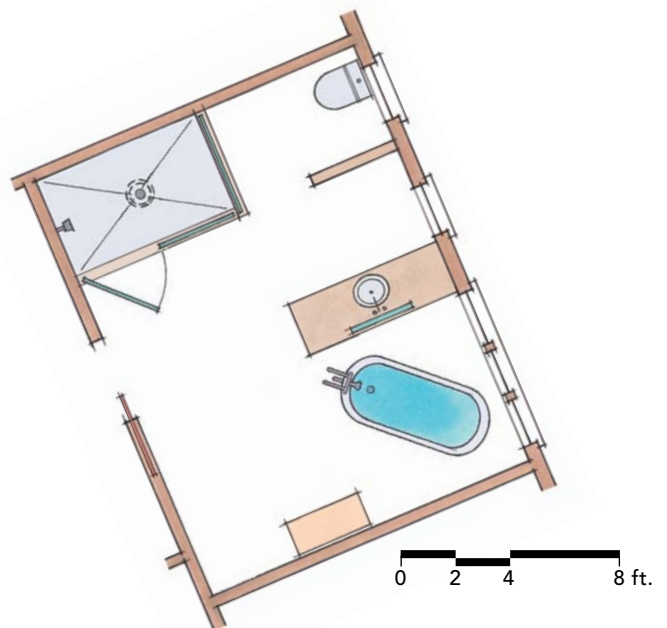

Traditional Country Bath

BY ANDY ENGEL



A clever arrangement makes a large space inviting

Part of a renovation of a Vermont house, this bathroom reflects the homeowner's desire for a clean, open look that continues the architectural language from the rest of the house.

Even though the bathroom is unusually large, numerous windows, the shower, and the door didn't leave wall space to accommodate a vanity. Additionally, the size of the space left anyone using the bath feeling exposed. The designer, Mitra Urich, solved both problems by placing the vanity and a suspended mirror perpendicular to the exterior wall to separate the workaday functions of shower, toilet, and vanity from the soaking tub.

Textures organize and set a tone

Mitra also used textures to define spaces. An example is the floor tile, which divides the room in half. Along the entry wall, a "rug" of large, reflective porcelain tile creates a more formal setting for several of the owner's antiques. Smaller, 4x4 tile fills the rest of the bath, distinguishing the space and providing a less slippery surface near the soaking tub.

Texture also differentiates wall spaces. A three-quarter-height wainscot unites the front half of the room, while painted drywall along two interior walls creates a canvas for the owner's period furniture. The simple color palette consists of a white ceiling that brightens the room, and gold-tone walls that repeat highlights in some of the furniture.

The detailing drawn from elsewhere in the house lends an air of relaxed formality. The contractor, Chris Conner, brought Mitra's design to life using locally sourced custom cabinets and millwork of painted poplar.

Andy Engel is a senior editor.
Photos by Susan Teare.



DETAILS

Tile Pratt & Larson C-58 (4x4), prattandlarson-or.com; Marazzi Saturnia porcelain (24x24), marazziusa.com

Wall color Sherwin Williams Row House Tan, sherwin-williams.com

Ceiling color Benjamin Moore Seashell, benjaminmoore.com

Trim color Benjamin Moore Calming Cream

Tub Victoria & Albert Roxburgh slipper tub, vandabaths.com

Tub filler Sigma floor mount with telephone handle, sigmafaucet.com

Shower controls and sink faucet Rohl, rohl.com

Ventilation Venmar two-speed HRV, venmar-usa.com

A space for each function. The shower, toilet, vanity, and soaking tub each is afforded its own space, separated by trim elements such as the floor tile, a suspended mirror, and a three-quarter-height wall.

Balanced bathing. Placed next to a wall of windows, the soaking tub faces obliquely inward, nodding to the house's rural setting while fostering a sense of privacy.

Designer Mitra Designs, Bristol, Vt.; mitradesigns.com

Builder Conner & Buck, Bristol, Vt.; connerandbuck.com