

# Light and Space

Strategic daylighting and an open plan make this modern master bath a unique retreat

BY FU-TUNG CHENG

Located in Los Altos Hills, Calif., this home demonstrates a lively relationship with natural elements in order to form a sense of warmth and intimacy. The master bath is on the second floor and echoes the clean lines seen throughout the large-scale, environmentally conscious home.

Part of the master suite, the bath has an open, loftlike feel achieved with high ceilings and windows, which allow natural light to fill the room. No door is required except to the lavatory, thanks to the bamboo cabinetry that creates privacy and separation between the shower, vanity, and bedroom areas.

To keep with the open plan, an amply spaced shower welcomes light through a full-height glass partition. Custom-designed tiles in the shower, a custom-cast concrete vanity, and a few simple, site-specific windows are some of the elements that distinguish this design from solutions the market specifies in similar circumstances.

Fu-Tung Cheng is founder and principal of Cheng Design in Berkeley, Calif.

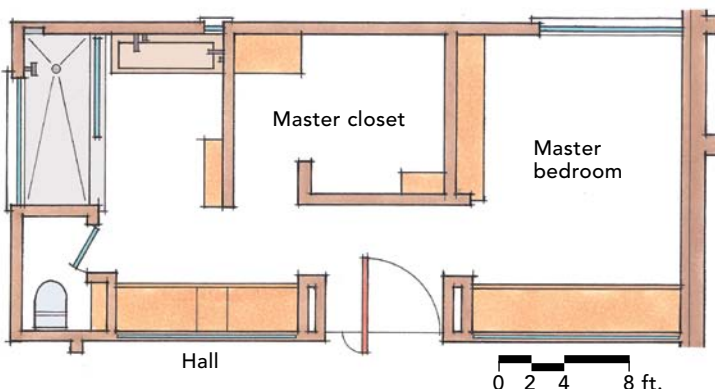

## SHOWER

The 4-ft. by 10-ft. shower features a lower ceiling created with a translucent, polycarbonate plenum at about 8 ft. to make it feel more intimate and to keep the warm vapor enveloping the user during showers. Above this plenum, skylights on the roof illuminate the shower with diffused, natural sunlight during the daytime. At night, the plenum glows with lighting placed between it and the roof.



## DETAILS

### Water fixtures

Hansgrohe, [hansgrohe-usa.com](http://hansgrohe-usa.com)

### Medicine cabinet

Robern M Series, [robern.com](http://robern.com)

### Shower tile

Holt tile, [Cheng Design, chengdesign.com](http://Cheng Design, chengdesign.com);

UltraGlas, [ultraglas.com](http://ultraglas.com)

### Shower pan

Ann Sacks Context, [annsacks.com](http://annsacks.com)

### Floor tile

Ann Sacks Nocchio

### Vanity

Custom Geocrete, [Cheng Design](http://Cheng Design)

Location Los Altos Hills, Calif.

Designer [Cheng Designs](http://Cheng Designs)

Builder R.J. Dailey Construction

## GLASS

A clerestory glass partition running the length of the hall bathes the master bedroom and bath on both sides with natural light. The clerestory is  $\frac{3}{8}$ -in. plate glass glazed with silicone to attenuate noise. The small, site-glazed, pivot window to the right of the vanity allows just enough fresh-air circulation and was designed to be light, small, and easy to use.

## TILE

The shower tile, by Cheng Design, is a crackle-glazed porcelain reminiscent of an antique Chinese teapot. Over the vanity wall, the tile switches to a horizontal iridescent glass tile by UltraGlas. Using both tiles creates an aesthetic dialogue between the ancient and the contemporary.

## VANITY

The concrete, ramped sink vanity is a functional sculpture. The fact that it looks like it is floating balances out the mass of the concrete.