





## TRADITIONAL DETAILS TIE IT ALL TOGETHER

While the arrangement of this bath's plan is structured around defined spaces, it feels completely unified. Here are the details that help make that happen, while giving the space a distinctly traditional vibe.

**1 NICKLE-GAP CLADDING** on the walls harkens back to the interior paneling found in the former home. It also provides texture to the space and visually connects the areas surrounding the vanities and the tub.

**2 RUNNING HEAD TRIM** that wraps the room and integrates seamlessly with the window and door casing acts as an anchor for the various openings and materials and lends a calm feeling to the space while providing a consistent visual and physical connective element.

**3 FRAME-AND-PANEL CABINET DOORS** on the vanities and built-in bookshelves with V-groove paneled backs help establish the style; they also tie the plan together as they mirror each other in the space.

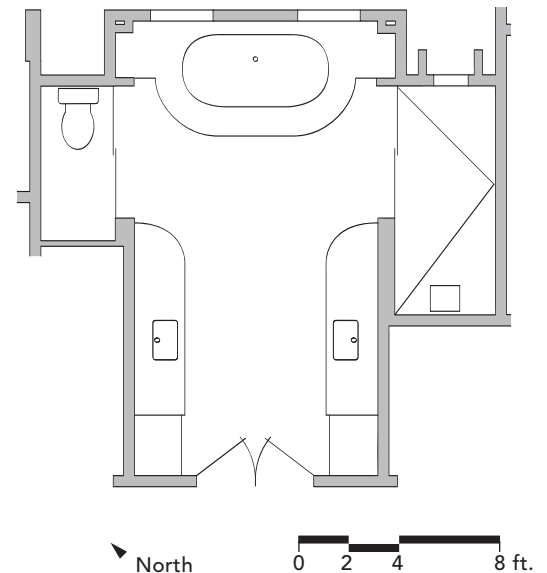

Because the homeowners enter this room on its centerline, there is a natural symmetry to the space. Just beyond the opposing, matching vanities is a water closet to the left and a shower to the right. Both have been detailed with the same deep blue Pratt & Larson 6-in. by 18-in. ceramic tiles that mimic the colors found in a late-afternoon ocean. These smaller spaces are set behind frameless glass doors in order to borrow light and views from the main space and its windows. The darker tile color in these areas contrasts with the bright neutral tones of the main space and draws out the dark blue accents in the mosaic tile floor, helping distinguish them further. Each space is distinct, but very much a part of the same design.

There are few places as tactile as a bathroom, and this goes for fixtures and materials as well—only a kitchen rivals a bathroom when it comes to the physical closeness we have to the things we use in these spaces. For that reason, and to create a visceral sense of qual-

ity, we take care in selecting the products we incorporate into these rooms and work with highly skilled and collaborative carpenters and craftspeople to ensure the work is executed to a very high standard.

When considering fixtures and hardware for a bathroom, value how they function and feel. For instance, here we've used shower fixtures, faucets, and a tub filler from the Waterworks Ludlow collection. Their polished nickel cross-handle valves help give the bath a traditional feel, and offer a heft and precision that is undeniable. Similarly, the solid Devon&Devon tub, Rocky Mountain Hardware pulls on the vanities, and lighting from The Urban Electric Co. help lend a sense of permanence to this space. When you experience this bath, you know its design will endure. □

Matthew Cramer, AIA, is a senior associate at Hutker Architects. Photos by Michael J. Lee.